

Rolfe East



Cedar Park, Sherborne, DT9 4FT

Price Guide £185,000

- STUNNING SECOND / TOP FLOOR APARTMENT WITH TWO DOUBLE BEDROOMS.
- BUILT IN 2021 AND HARDLY USED - 'AS NEW' CONDITION!
- TEN YEAR NHBC.
- ALLOCATED PARKING FOR ONE CAR IN SECURE, GATED RESIDENTS PARKING AREA.
- STYLISH OPEN-PLAN LIVING WITH JULIET BALCONY.
- GREAT LEVELS OF NATURAL LIGHT.
- MODERN ELECTRIC HEATING AND uPVC DOUBLE GLAZING.
- SHORT WALK TO SURROUNDING COUNTRYSIDE AND SHERBORNE TOWN CENTRE.
- SHORT WALK TO RAILWAY STATION TO LONDON WATERLOO.
- NO FURTHER CHAIN.

80 Cheap Street, Sherborne, Dorset, DT9 3BJ
01935814929

sherborne@rolfe-east.com
<https://www.rolfe-east.com/>

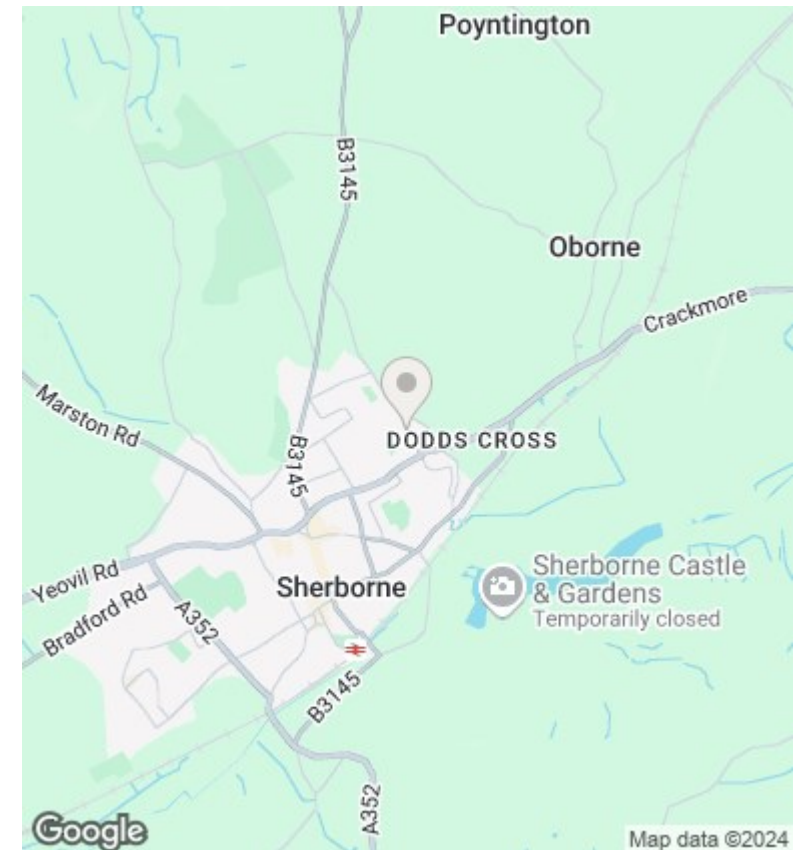
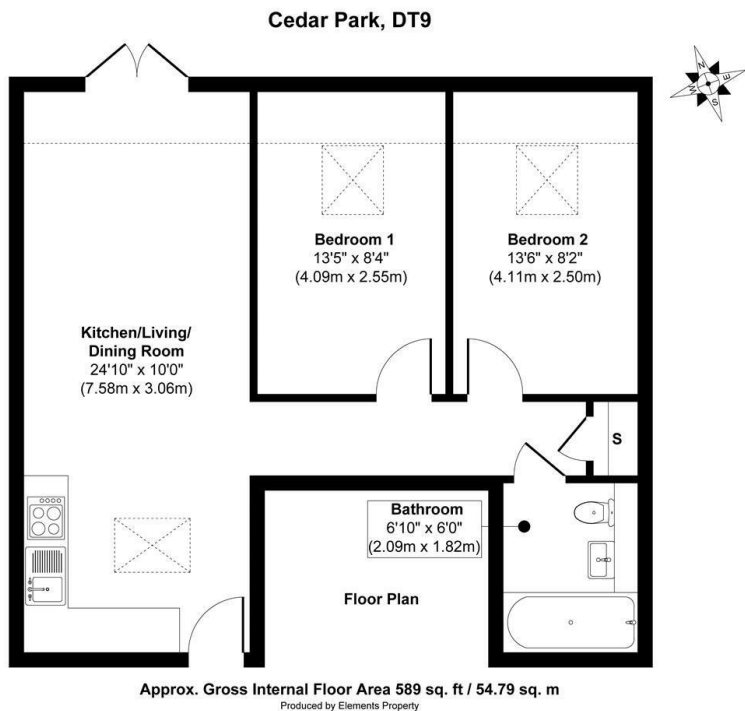

Directions

Viewings

Viewings by arrangement only.
Call 01935814929 to make an appointment.

Council Tax Band

B

EPC Rating:

Energy Efficiency Rating		
	Current	Potential
Very energy efficient - lower running costs		
(92 plus) A		
(81-91) B		
(69-80) C		
(55-68) D		
(39-54) E		
(21-38) F		
(1-20) G		
Not energy efficient - higher running costs		
England & Wales	EU Directive 2002/91/EC	